

Portable Humidifier – help guide

The *Harry* Humidifier

For humidity control 40%-60% for most conservation applications

We recommend changing the setting to **45% during frosty weather, unless you have a plumbed in (auto-fill) . This is because the tank may need filling too often to keep up with, and humidity shall drop when the tank empties (eg. overnight, weekend, bank hols etc.) Otherwise, 50% is the best setting.*



Thank you for choosing the Novatron Harry portable humidifier. This machine is capable of managing a room volume of up to 300 cubic metres to achieve 50 % relative humidity at room temperature with one air change of the room volume per hour.

Both air filtration and humidifying are benefits of the Harry.

The Harry is supplied pre-commissioned and is **set at 50% rh** on maximum fan speed which will provide quiet operation and should allow you maintain control within 40 – 60 % rh even with some extra air losses and the occasional emptying of the water tank overnight.

The keypad is touch screen and the controls are locked to prevent inadvertent changes . To unlock the control simply press and hold the centre of the touch screen padlock symbol for a few seconds and the same to re-lock it again.

The water tank may need more regular filling during frosty or very cold weather when indoor relative humidity is very low.

What if ?

The desired humidity isn't being reached?

Raise the fan speed but not the humidity setting of 50%

The room humidity is higher than the set point?

Room humidity may rise temporarily above 50% during wet weather

The humidifier is using water regularly but the desired humidity isn't reached?

Ensure that you are not losing humidified air – check doors, windows, ventilation systems etc.

The empty water tanks red indicator shows yet the tank is full ?

Check that the water level float sensor inside the basin(at the rear where the water tank goes) is not stuck.

The humidifier works well but smells unpleasant?

Clean out and flush the basin with household disinfectant . This is easily removed from the front of the machine once you have taken off the water tank, then front panel and filter that all simply clip into place. Possibly replace evaporator mat. Request service visit from Novatron.

- *Encapsulated external power supply at rear
- *Touch screen control panel at top
- *Current humidity display shown on readout
- * Fan speed indicator
- * Indicator bar – progress towards set-point
- * Emotv water tank red indicator

Control Panel

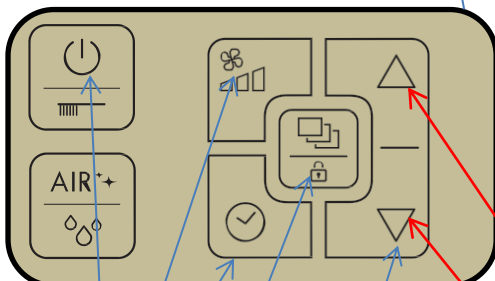

- ON / OFF
- FAN SPEED
- TIMER
- KEY PAD LOCK (hold 5 secs and LC is displayed)
- UP / DOWN keys

Press and hold simultaneously for 2 seconds to *clear all warning indications*

Indicators and warning lights

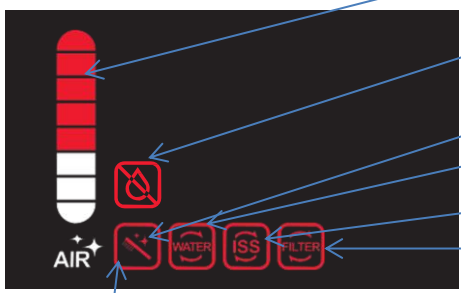

- Air quality indicator
- Refill water
- Cleaning required(p.58 of manual)
- Change water
- Replace Ioniser silver stick (p.66 of manual)
- Replace hybrid filter (p.64 of manual)

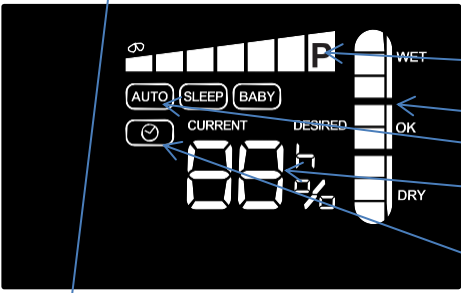

- Fan speed
- Humidity indicator bar
- Mode – select AUTO
- Current or desired humidity %
- Timer



Routine de-scaling

When the de-scaling indicator appears please follow these instructions :-

- *Clean humidifier out thoroughly (see p3. below for help)
- *Optional use of Calc Off (not supplied)

***PRESS & HOLD the on/off button for 5 seconds.**

Set the time to 1 hour using the Up / Down keys :

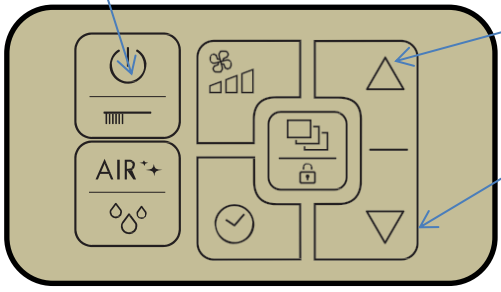

- * Wait 1 hour .
 - *Should Calc Off have been used, flush out basin and wash all internal parts after the de-scaling cycle.
- The cleaning warning light should now vanish.

Assembly of parts

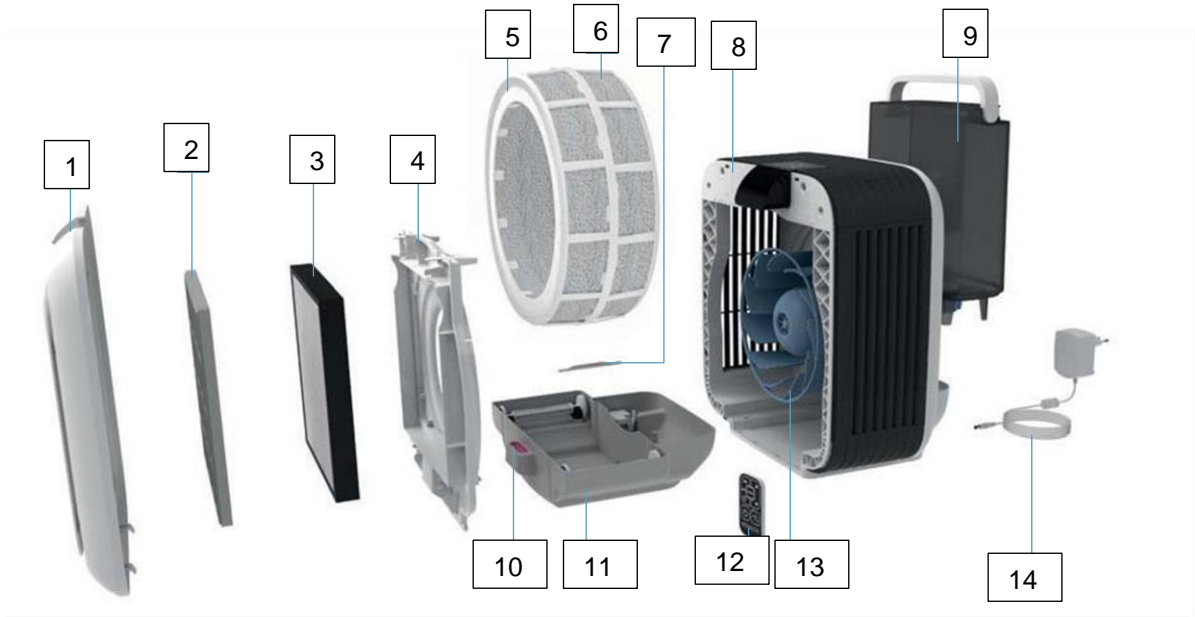

- 1 Front cover
- 2 Pre-filter
- 3 HYBRID filter
- 4 Filter holder
- 5 Drum
- 6 Evaporator mat
- 7 Ionic Silver Stick®
- 8 BONECO H680
- 9 Water tank
- 10 Fragrance container
- 11 Water base
- 12 Remote control
- 13 Fan blade
- 14 Power supply

Taking apart for cleaning

1. Remove the front cover and the water tank on the rear side.
3. Pull the water base out and remove the drum with the evaporator mat.



2. Remove the filter holder together with the filter.



4. Empty water base / water tank and clean out with some mild disinfectant



5. Set the drum back into the water base and put the appliance back together by following the steps in reverse order.



Novatron Scientific Ltd., Novatron House, 46 London Road, Horsham, West Sussex RH12 1AY
 Tel: +44 (0)1403 754416 Fax: +44 (0)1403 754480 email: sales@novatron.co.uk
 website: www.novatron.co.uk